

On-Site Corrective Actions Update

Former DuPont Waynesboro Plant
October 25, 2016

Introduction

- Background
- Actions Completed
- Proposed Remedies
- Upcoming Activities
- Ongoing Activities



Background

- RCRA Facility Investigation (RFI)
 - Conducted 2001 - 2010
 - Approved in 2015
- Findings
 - Hg in former structures (SWMU's 1 and 4)
 - Sources have impacted storm sewer – outfall discharges
 - Impacted groundwater limited to former Hg areas

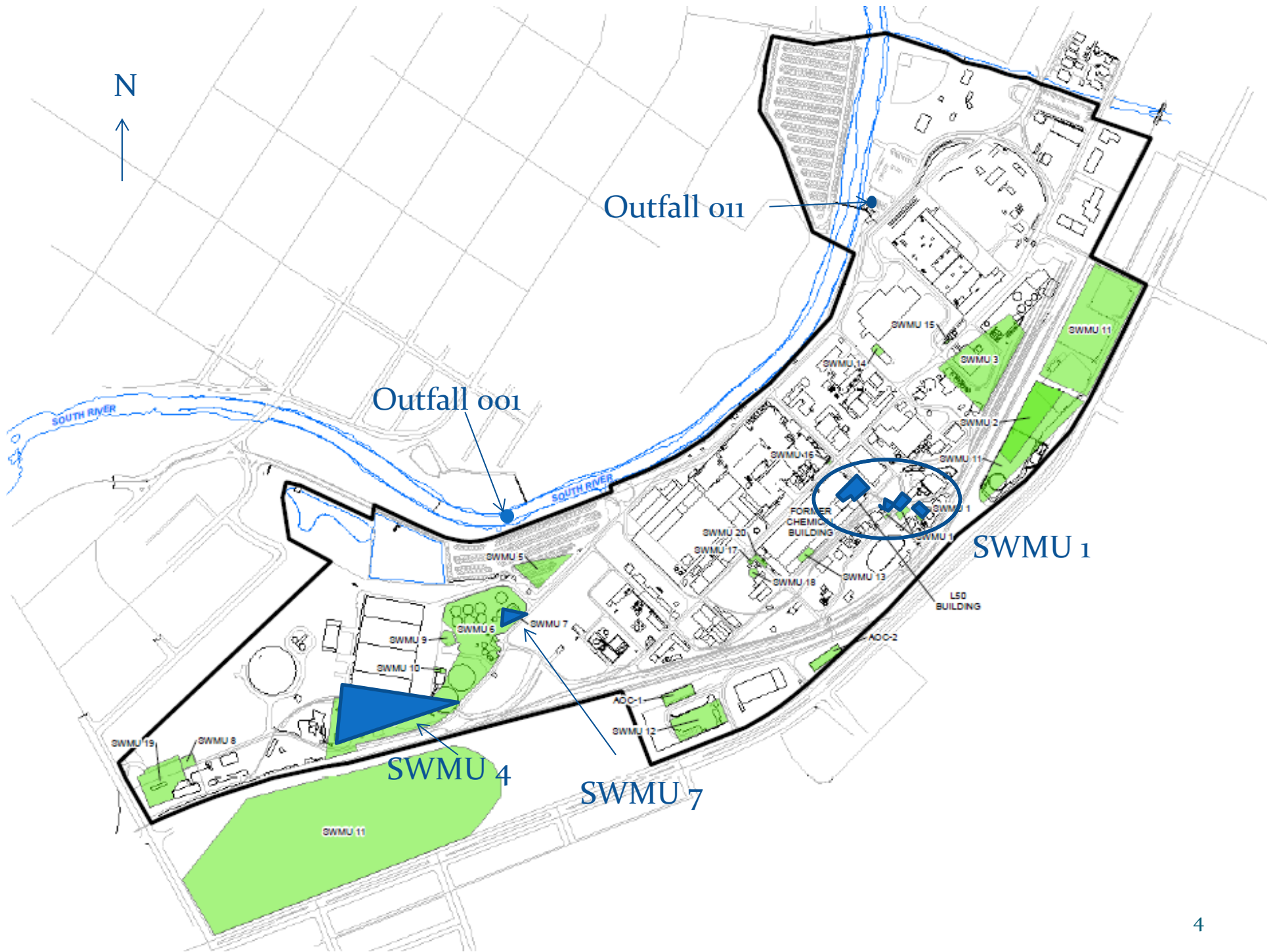



Actions Completed

- Interim Measures (2010)
- Sewer Investigation (2010)
- Railroad Ave Interim Measures (2014)
- RFI (approved 2015)
- Corrective Measures Study (2016)



Proposed Remedies

- Hg source area Excavations – SWMUs 1 and 4
- Capping – SWMUs 1, 4 and 7
- Long Term Groundwater Monitoring – Technical Impracticability (TI) – SWMUs 1, 4 and 7
- Final Sewer Clean-out – AOC 3
- Institutional Controls - SWMUs 2, 6, 17 and AOC 1

Proposed Remedy – SWMU 1

- Free Hg Source Removals
- Asphalt Cap
- GW Monitoring (TI)

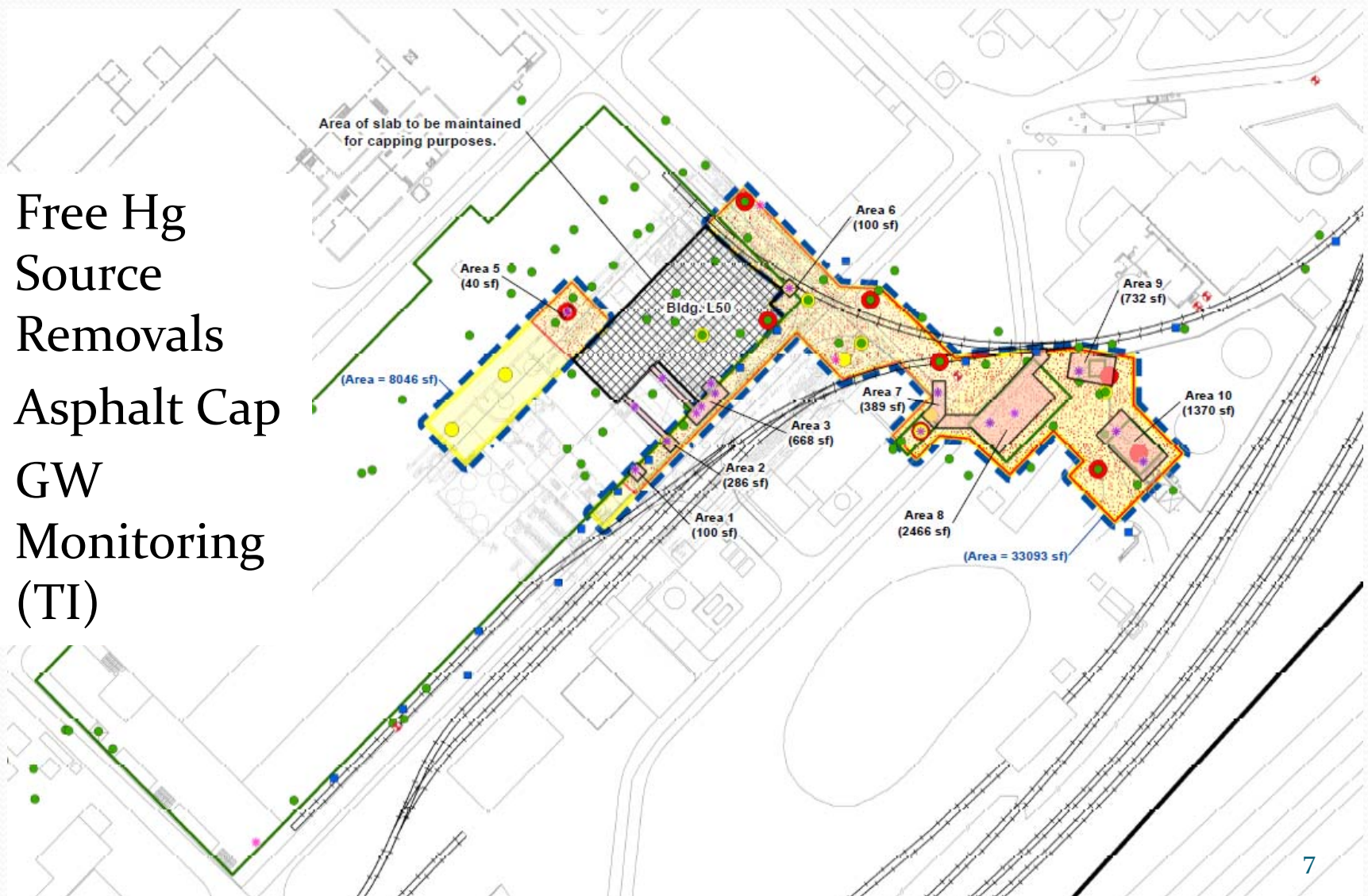

Proposed Remedy – SWMU 4

- Free Hg Source Removals
- Cap, re-grading
- GW Monitoring (TI)

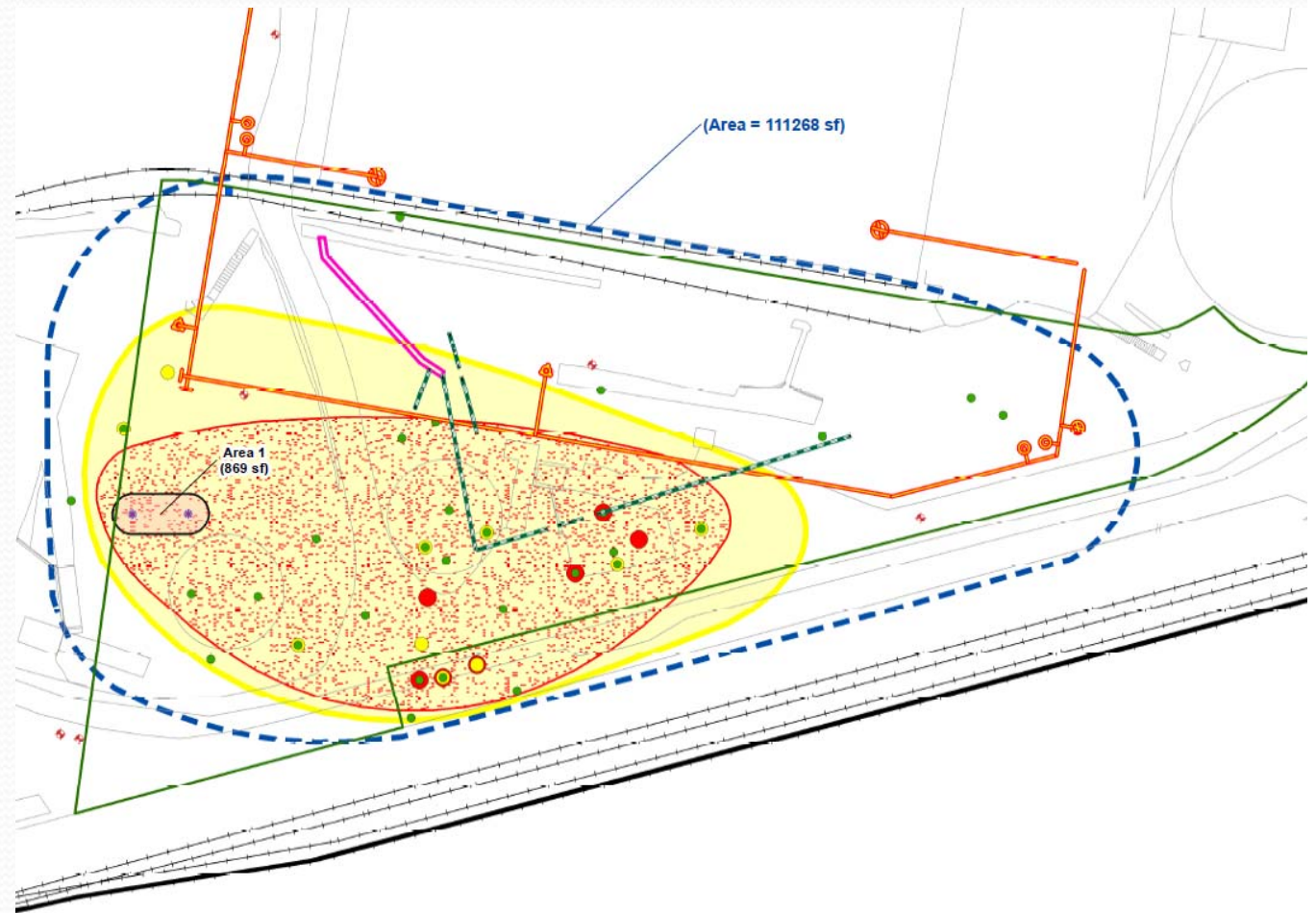

Proposed Remedy – SWMU 7

- Asphalt Cap
- GW Monitoring (TI)



Proposed Remedy – AOC 3

- Cleanout, re-line, abandon

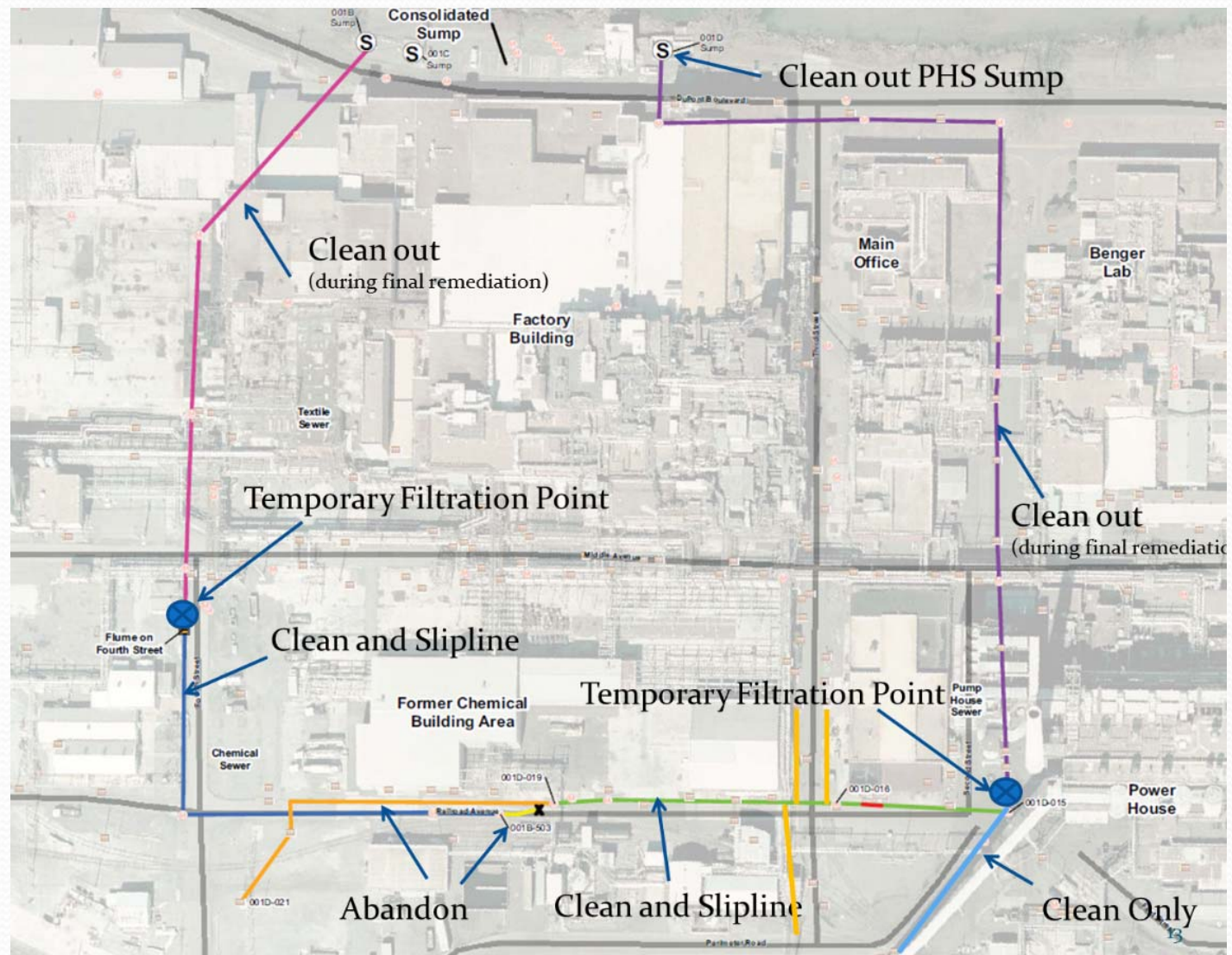

Upcoming Activities

- Final Agency Approval of CMS – Statement of Basis
- RCRA Permit Modification
- Corrective Measures Implementation (CMI)
 - CMI Workplan
 - CMI Design Report – additional permit modification
 - CMI Construction (anticipated in Fall 2017)



Ongoing Activities

- Groundwater Monitoring
 - Revised Program – Annual Sampling
- Outfall Monitoring
 - Monthly Sampling at Outfalls 001, 011
- Mercury Inspections



Questions?