

# On-Site Corrective Actions Update

Former DuPont Waynesboro Plant

April 5, 2016

# Introduction

- Background
- Actions Completed
- CMS
- Proposed Remedies
- Ongoing Activities





# Background

- RCRA Facility Investigation (RFI)
  - Conducted 2001 - 2010
  - Approved in 2015
- Findings
  - Hg in former structures (SWMU's 1 and 4)
  - Sources have impacted storm sewer – outfall discharges
  - Impacted groundwater limited to former Hg areas

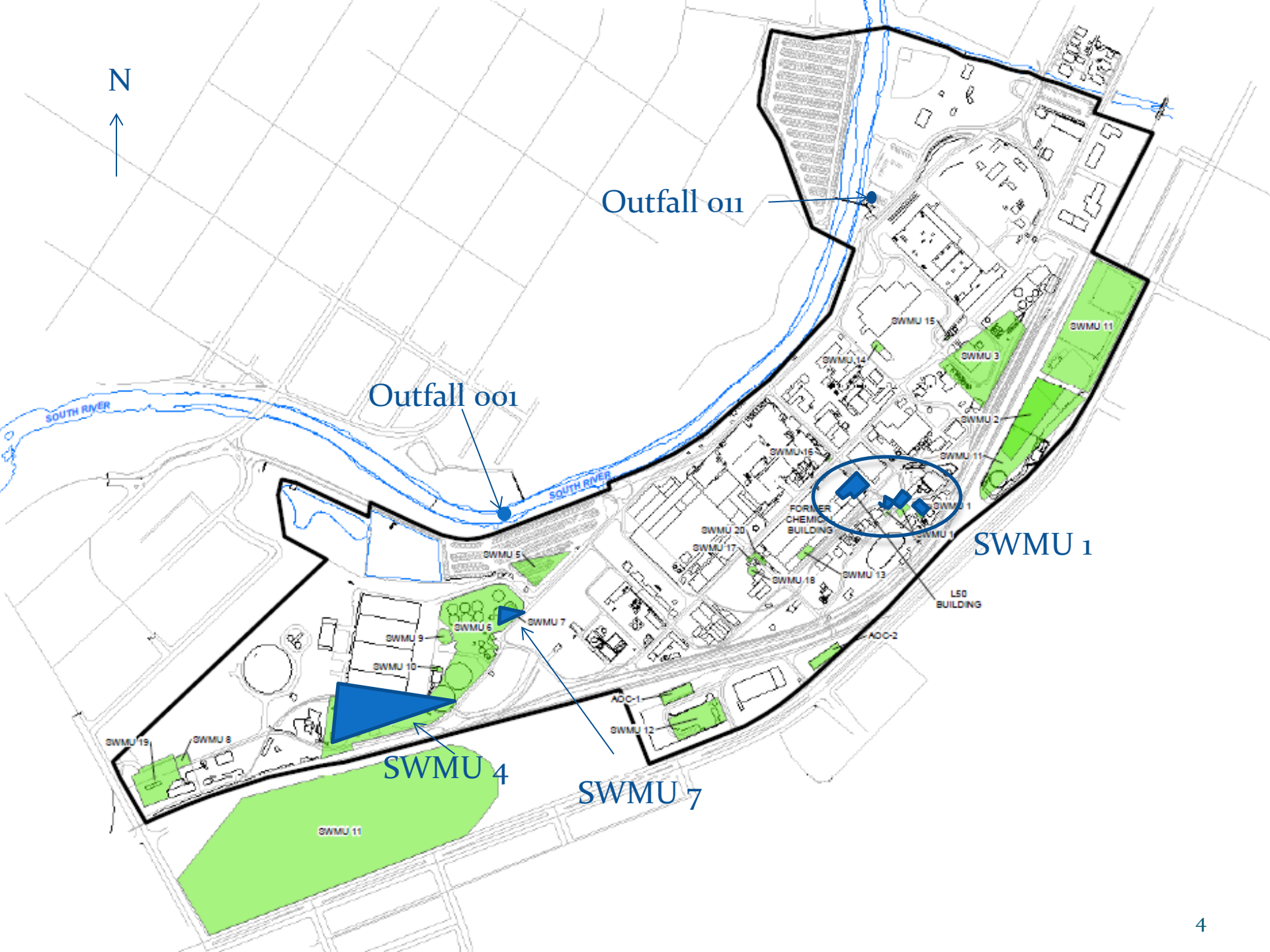



# Actions Completed

- Interim Measures (2010)
- Sewer Investigation (2010)
- Railroad Ave Interim Measures (2014)
- RFI (approved 2015)

# Corrective Measures Study

- Final Revision Pending Agency Approval
- Remedial Options Studied for:
  - SWMU 1 – Former Mercury Area
  - SWMU 4 – Former Incinerator Area
  - SWMU 7 – Former Sludge Pond
  - AOC 3 – Storm Sewer (Outfall) System
- Technologies Identified and Evaluated
  - Field and Bench Tests
  - EPA “Balancing Criteria”
  - Sustainability Analysis



# Proposed Remedy – SWMU 1

- Free Hg Source Removals
- Asphalt Cap
- GW Monitoring (TI)

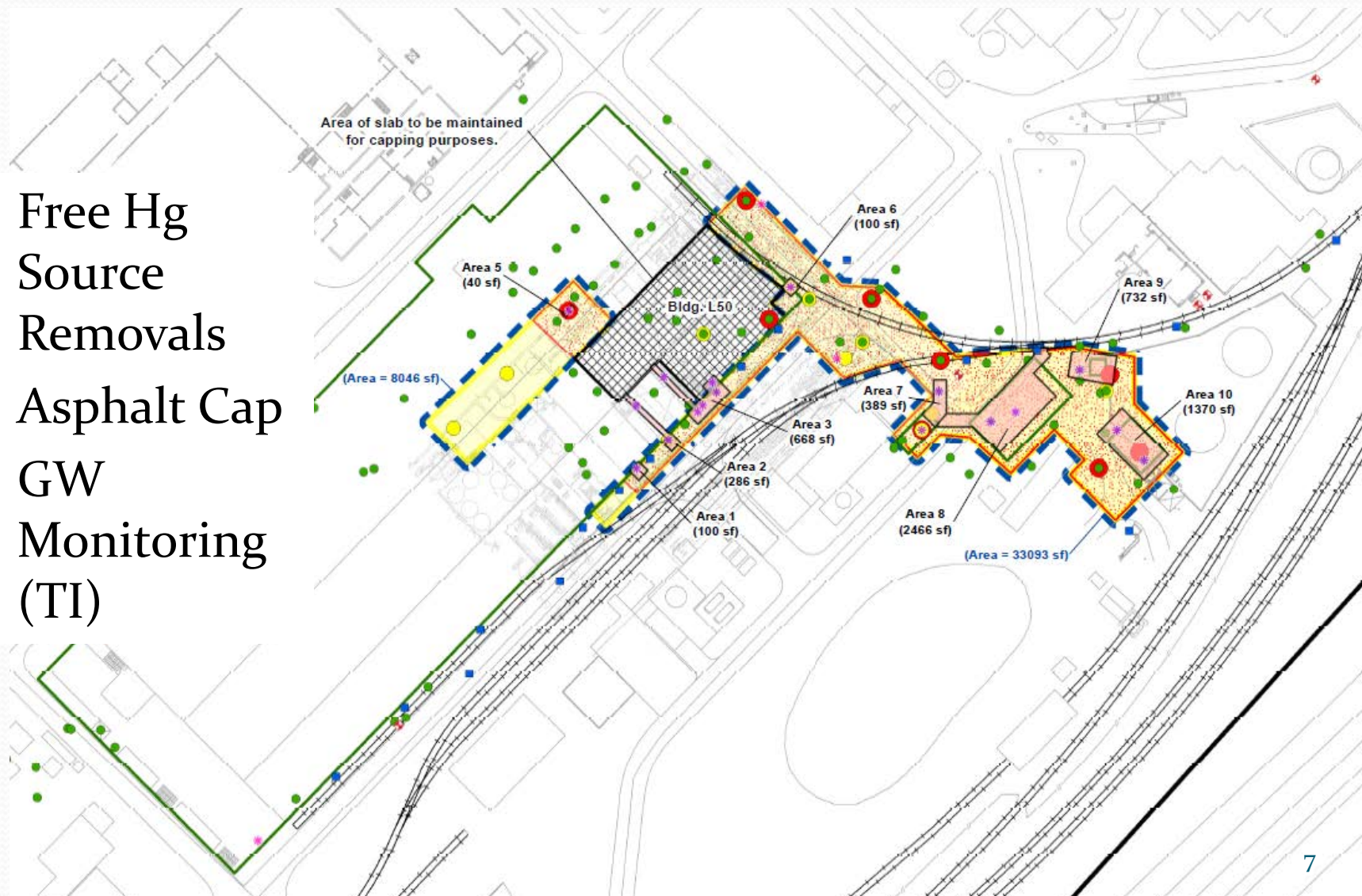

# Proposed Remedy – SWMU 4

- Free Hg Source Removals
- Cap, re-grading
- GW Monitoring (TI)

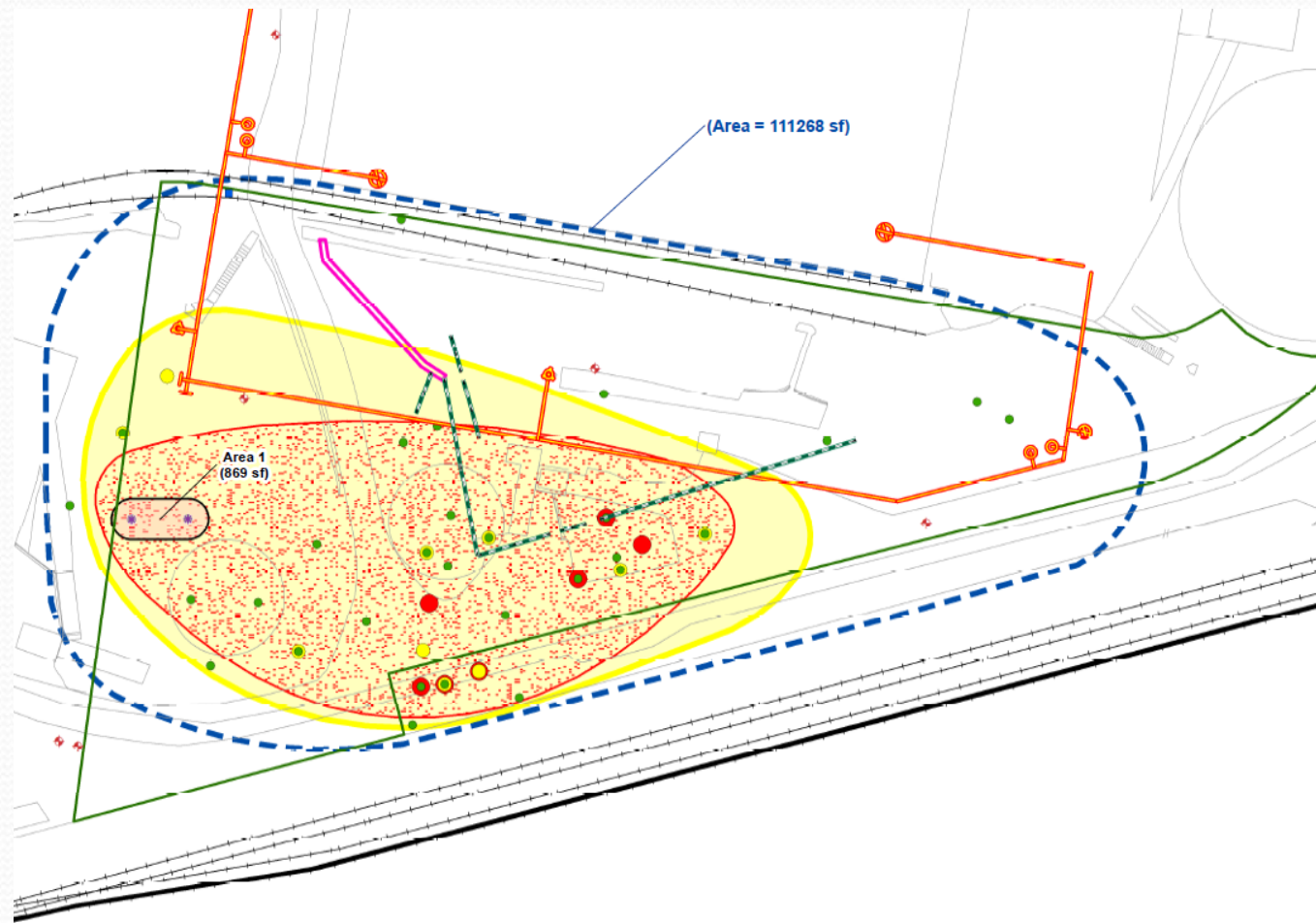



# Proposed Remedy – SWMU 7

- Asphalt Cap
- GW Monitoring (TI)



# Proposed Remedy – AOC 3

- Cleanout, re-line, abandon

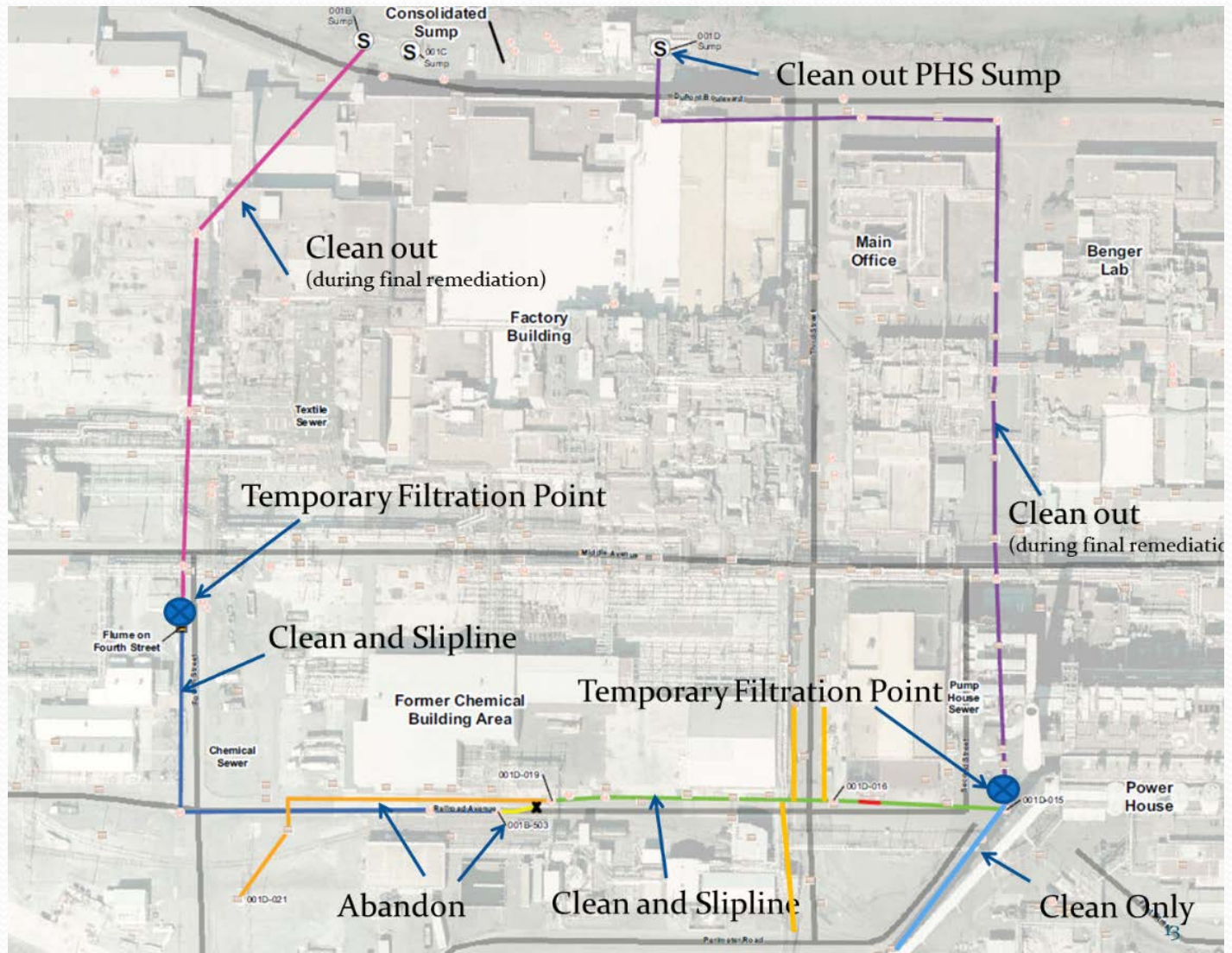



# Institutional Controls

- SWMUs Proposed for Institutional Controls
  - SWMU 2 - (Ash Disposal Area)
  - SWMU 6 - (Wastewater Treatment)
  - SWMU 17 - (Orlon Sump)
  - AOC 1 - (Drum Storage Pad)

# Ongoing Activities

- Groundwater Monitoring
  - Revised Program – Annual Sampling
- Outfall Monitoring
  - Monthly Sampling at Outfalls 001, 011
- Mercury Inspections





Questions?